

**Metal Building Roof Curb Application Guide
Models UMB-1, UMB-2, UMB-3, & UMB-4**

MODEL UMB-1

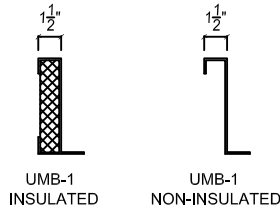

One Piece Curb with Integral Rib closures for use with R & SSR panels.

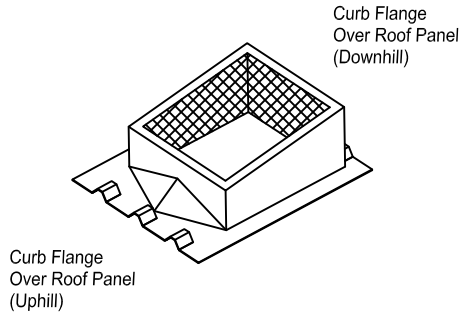
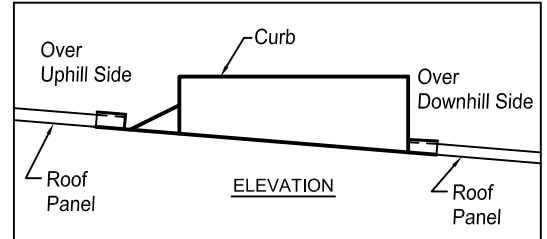

MODEL UMB-2

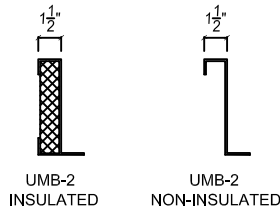
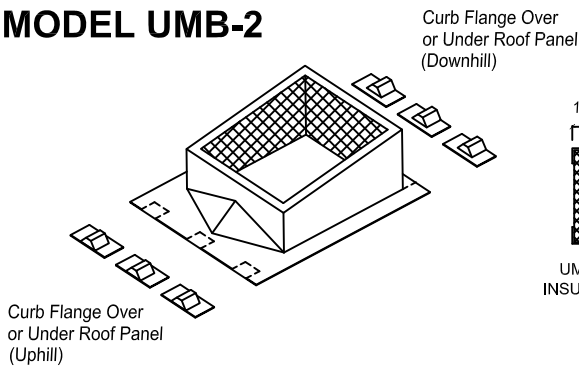

One Piece Curb with Loose Rib closures for use with R & SSR panels.

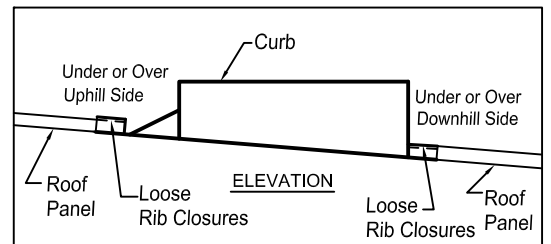

MODEL UMB-3

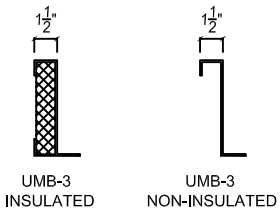
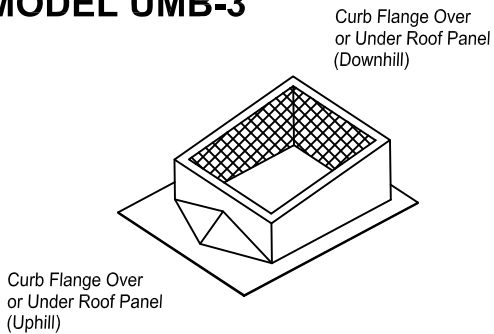

One Piece Curb with flat flanges for use on Vertical Architectural SSR Panels

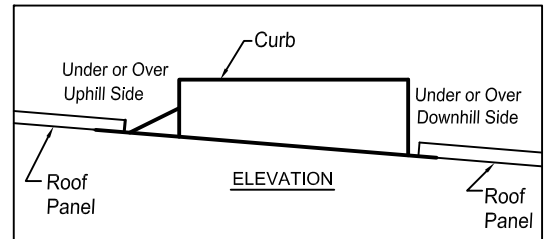

MODEL UMB-4

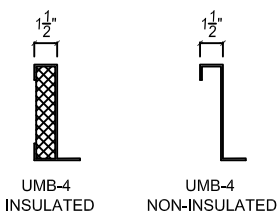
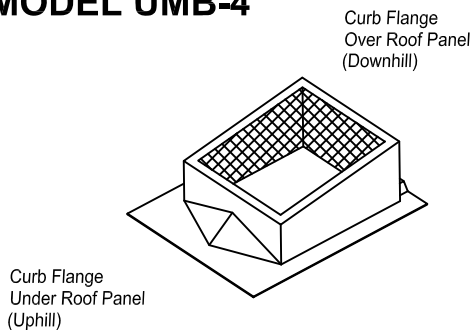

One Piece Curb with Integral Rib closures (downhill side) for use with R & SSR panels.

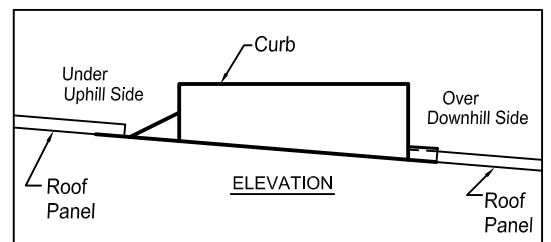

Job Name:	DRAWN BY: CLJ	DATE: 4-18-06	REV. DATE: 1-4-11
Location:		REV. NO. 2	APPROVED BY: CBY
Architect:			DWG. NO.: M-17
Engineer:			
Contractor:			

**Metal Building Roof Curb Application Guide
Models UMB-5, UMB-6, UMB-7, & UMB-8**

MODEL UMB-5

Curb Flange
Over Roof Panel
(Downhill)

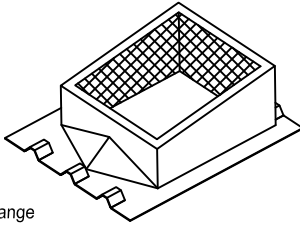

Curb Flange
Under Roof Panel
(Uphill)



UMB-5
INSULATED

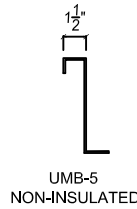

UMB-5
NON-INSULATED

One Piece Curb with Integral Rib
Closures for use with R & SSR panels.

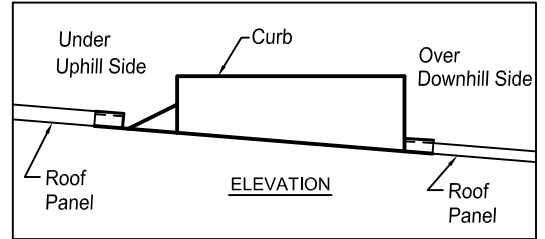

MODEL UMB-6

Rib Closure plate
Over Roof Panel
(Downhill)

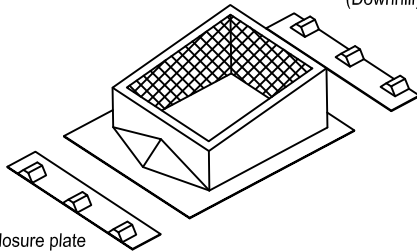

Rib Closure plate
Under Roof Panel
(Uphill)



UMB-6
INSULATED

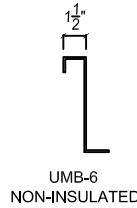

UMB-6
NON-INSULATED

Three Piece Curb with Integral Rib Closures
on plates for use with R & SSR panels.

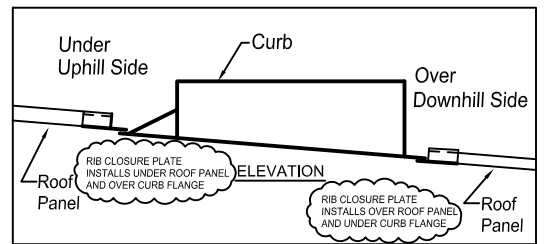

MODEL UMB-7

Curb Flange
Over Roof Panel
(Downhill)

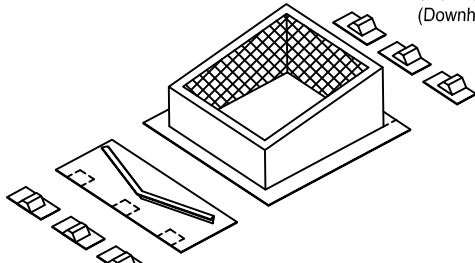

Diverter
Under Roof Panel
(Uphill)



UMB-7
INSULATED

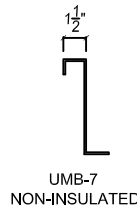

UMB-7
NON-INSULATED

Two Piece Curb with Loose Rib
Closures for use with R & SSR panels.

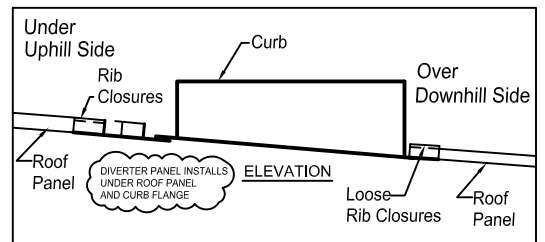

MODEL UMB-8

Curb Flange
Over Roof Panel
(Downhill)

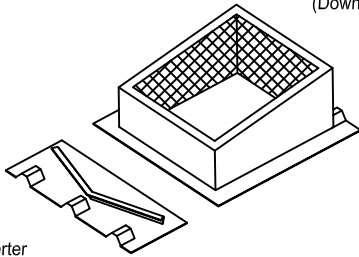

Diverter
Under Roof Panel
(Uphill)

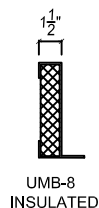

UMB-8
INSULATED

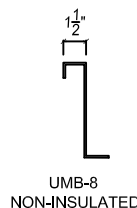

UMB-8
NON-INSULATED

Two Piece Curb with Integral Rib
Closures for use with R & SSR panels.

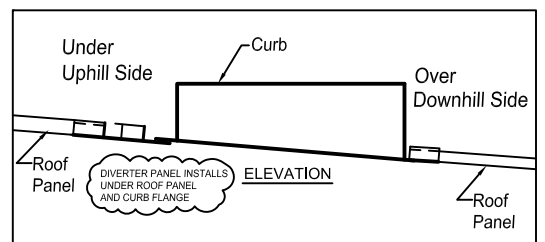

Job Name:	DRAWN BY: CLJ	DATE: 4-25-06	REV. DATE: 1-4-11
Location:			
Architect:	REV. NO. 3	APPROVED BY: CBY	DWG. NO.: M-18
Engineer:			
Contractor:			