

OPTIONAL ACCESORIES

HOT WATER COIL

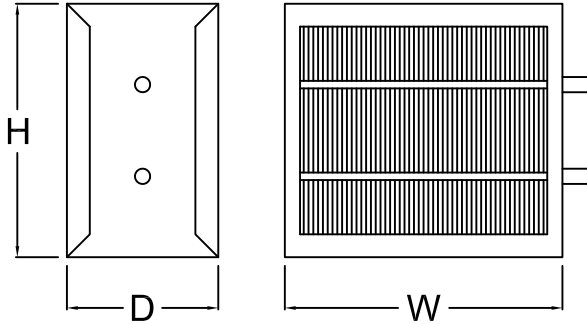

(ARI Certified)

INLET SIZE	H	W	D	Water Connection		
				1R	2R	3R
4,5,6	8	12	5	1/2"	7/8"	7/8"
7,8	10	12	5	1/2"	7/8"	7/8"
9,10	12-1/2	14	5	1/2"	7/8"	7/8"
12	15	16	5	1/2"	7/8"	7/8"
14	17-1/2	20	7-1/2	1/2"	7/8"	7/8"
16	18	24	7-1/2	1/2"	7/8"	7/8"
24 X16	18	38	5	1/2"	7/8"	7/8"

STANDARD FEATURES:

- 10 Fins per inch
- Fin Material: Aluminum
- Tube Material: Copper

- 1 ROW
- 2 ROW
- 3 ROW

ELECTRIC COIL

- MOUNTED AS INTEGRAL PART OF PRI-FL
- SHIPPED LOOSE

STANDARD FEATURES:

- Galvanized steel control box with 1/2" insulation and hinged cover.
- Primary and secondary over-temperature protection
- De-energizing definite purpose contactors
- Differential pressure fan interlock (air flow switch)
- 24 Volt transformer
- Fusing if heater exceeds 48 Amps per NEC
- Line and control terminal blocks
- UL Listed

SUPPLY VOLTAGE (Check Selection)

- 208 V, 1ph, 60 Hz
- 240 V, 1ph, 60 Hz
- 277V, 1ph, 60 Hz
- 208 V, 3ph, 60 Hz
- 480 V, 3ph, 60 Hz (4 wire wye)

OPTIONS (Check Selection)

- Mercury Contactors
- Quiet Contactors
- Fuse Box
- Disconnect Switch, door interlock
- Type, fused
- Manual reset secondary protection
- 80-20 Nickel-CA
- 35 Watts per square inch resistance wire

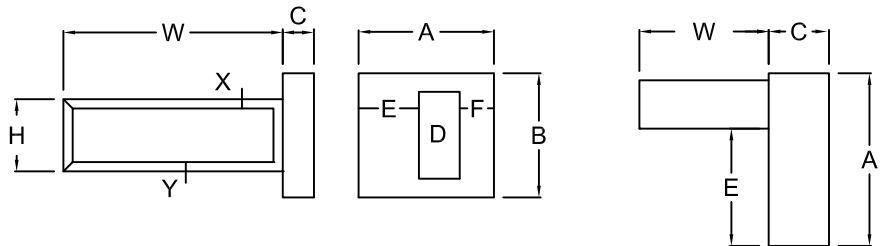

Dimensions - fill in if critical							
A	B	C	D	E	F	X	Y

X, Y, & F standard 1"
W = Duct Size minus Approximately 1"
H = Duct Size minus Approximately 2"

CALCULATE AMPS	
Single Phase	Three Phase
120Volts: Kw x 8.333 = Amps	
208Volts: Kw x 4.888 = Amps	208Volts: Kw x 2.774 = Amps
230Volts: Kw x 4.349 = Amps	230Volts: Kw x 2.09 = Amps
240Volts: Kw x 4.167 = Amps	240Volts: Kw x 2.404 = Amps
277Volts: Kw x 3.61 = Amps	277Volts: Kw x 1.254 = Amps
480Volts: Kw x 2.083 = Amps	480Volts: Kw x 1.206 = Amps

Example:
RH/LH Duct Heater Controls Location

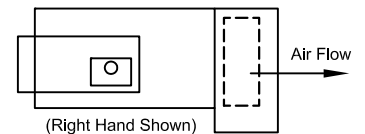

Job Name:

Location:

Architect:

Engineer:

Contractor:

OPTIONAL ACCESORIES

DRAWN BY:
CLJ

DATE:
12-01-91

REV. DATE:
01-04-11

REV. NO.
10

APPROVED BY:
BGT

DWG. NO.:
L-15