

APPLICATION

When ceiling cavity height is restricted, Oval Inlets can accommodate reduced height on plenums

Round Inlet Size	Oval Conversion Size Major Axis x Minor Axis
4"	4 ⁷ / ₁₆ " x 3 ¹ / ₄ "
5"	6" x 3 ¹ / ₄ "
6"	6 ¹ / ₄ " x 5 ¹ / ₄ "
7"	8" x 5 ¹ / ₄ "
8"	9 ³ / ₈ " x 5 ¹ / ₄ "
9"	11 ¹ / ₈ " x 5 ¹ / ₄ "
10"	12 ¹ / ₂ " x 5 ¹ / ₄ "
12"	15 ⁵ / ₈ " x 5 ¹ / ₄ "
14"	17 ⁷ / ₈ " x 7 ¹ / ₄ "

Available on all models (except PL-X)

NOTE: Overall Height of Plenum can be reduced using oval inlets - see minor axis dimension indicated above

Models SP-N, SP-L, and SP-EX have Standard 9" heights

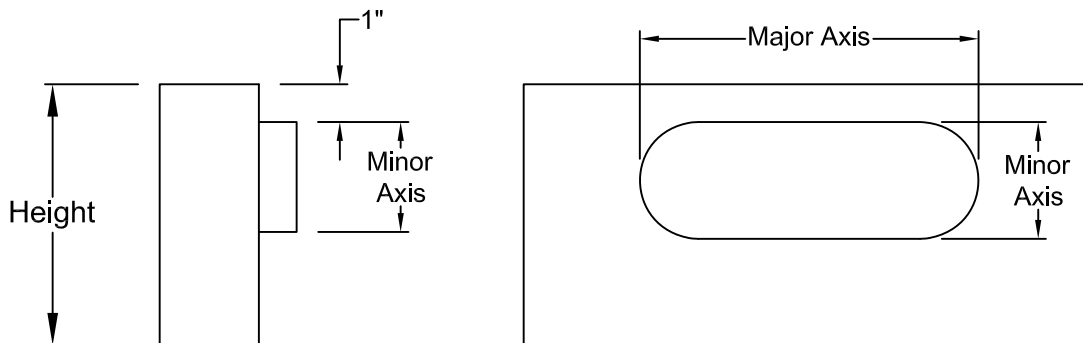

See Dwg. H-2 for Plenum Descriptions

Job Name:	OVAL INLETS		
Location:			
Architect:	DRAWN BY:	DATE:	REV. DATE:
Engineer:	TBL	01-14-09	11-8-10
Contractor:	REV. NO.	APPROVED BY:	DWG. NO.:
	2	BGT	I-6