

SUBMITTAL DATA

MODEL ES-RD-4V 4" [102mm] Aluminum Equipment Screen Vertical Blade

STANDARD CONSTRUCTION:

FRAME: 2" x 2" x 0.25" [51mm x 51mm x 6.35mm] thk. angle (6063-T5 Extruded)

BLADES: 4" [102mm] deep, 0.081" [2.06mm] thk. 6063-T5 Extruded Aluminum

FINISH: Mill

MAX. SINGLE SECTION: 84"w x 120"h or 120"w x 84"h [2134mm x 3048mm or 3048mm x 2134mm]

MIN. SECTION SIZE: 12"w x 12"h [305mm x 305mm]

*Panels over 48" [1219mm] wide will have a 2" x 2" x 0.25" [51mm x 51mm x 6.35mm] aluminum angle with blade supports mid-span

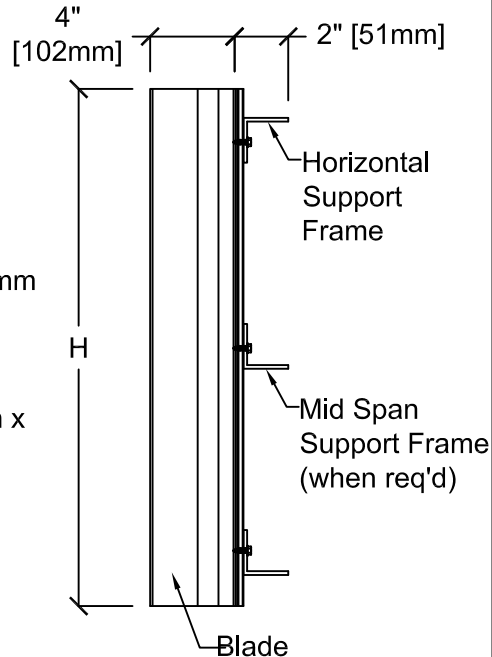

AVAILABLE FINISHES:

- Durable Polyester (AAMA 2604)
- 70% PVDF Fluoropolymer (AAMA 2605)
- Yellow Primer
- Clear Anodize
- Dark Bronze Anodize

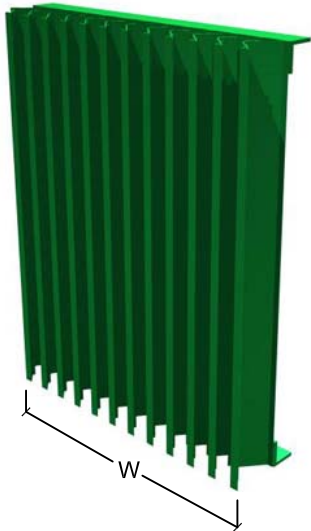

Non-post corner detail (standard)

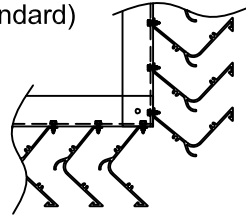

Post corner detail (optional)

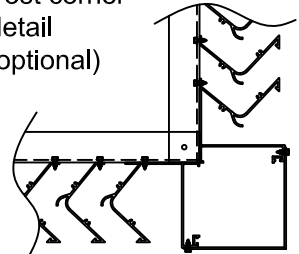

Continuous Line Detail

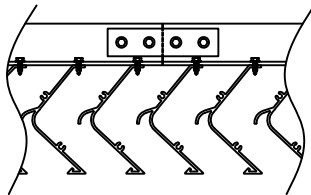

Due to continuing research, United EnerTech reserves the right to change specifications without notice.



3005 South Hickory Street
 Chattanooga, Tennessee 37407
 Tel: (423) 698-7715
 Fax: (423) 698-6629
 www.unitedenerotech.com

MODEL ES-RD-4V 4" [102mm] Aluminum Equipment Screen Vertical Blade)

DRAWN BY: MHM	DATE: 3-17-10	REV. DATE: 5-7-13	REV. NO.: 2	APPROVED BY: BGT	DWG. NO.: A-49
------------------	------------------	----------------------	----------------	---------------------	-------------------

Model ES-RD-4V Typical Installation Details

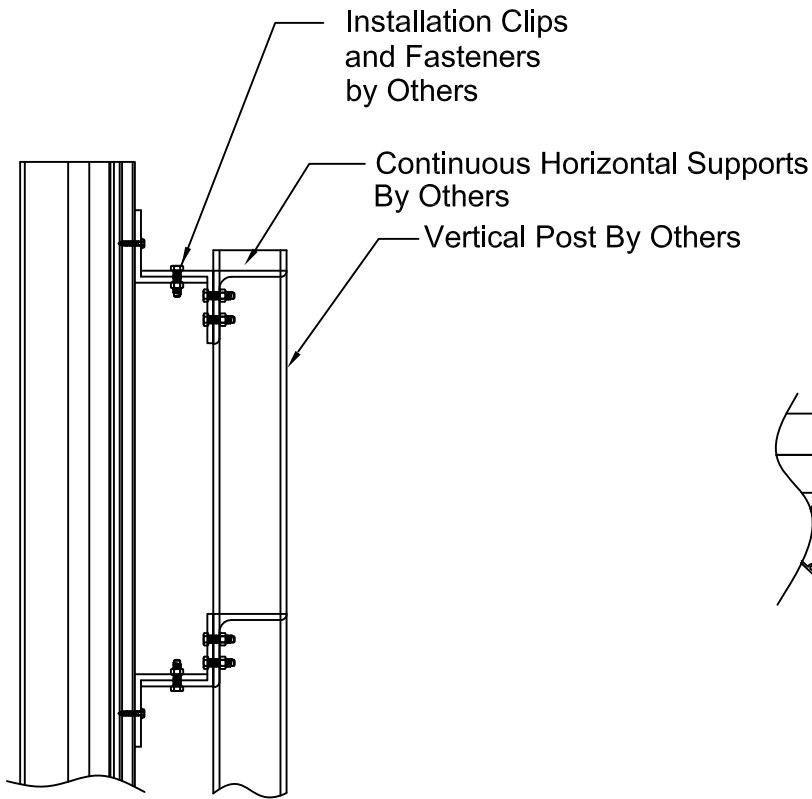

Elevation

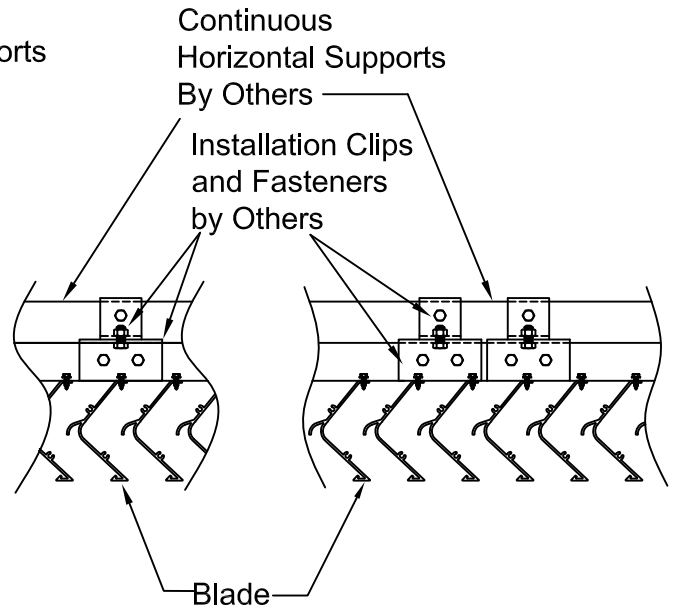

Plan view
(horizontal supports)

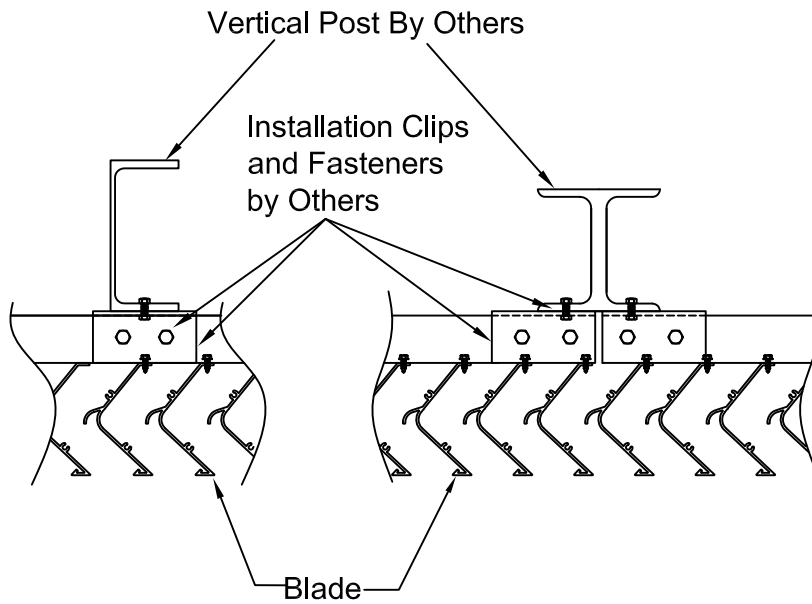

Plan view
(vertical supports)