

MANUAL DAMPERS

The Model RD is a G-90 galvanized steel damper with factory mounted with heavy duty locking hand quadrant designed especially for manual balancing applications. It is easy to install, seal, and becomes part of the duct work.



MODEL RD

approx. 1/8" (3.1mm) o.d. undersized

DIAMETER	LENGTH	BODY & BLADE
4 - 10" (102 - 254mm)	8" (203mm)	20 ga.
12 - 18" (305 - 457mm)	8" (203mm)	20 ga.
20 - 30" (508 - 762mm)	8" (203mm)	20 ga.
32 - 40" (813 - 1016mm)	8" (203mm)	18 ga.

SHAFT:

- 3/8" (9.5mm) square steel axle pins (thru 16" (406mm))
- 1/2" (12.7mm) round solid aluminum (18"(457mm) thru 30"(762mm))
- 3/4" (19mm) round solid steel (32"(813mm) thru 40"(1016mm))

BEARING:

Molded synthetic
 Nylon 6/6

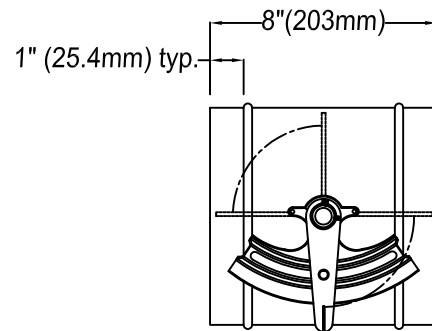

VARIATIONS:

- Stainless steel body, blade, shaft and quadrant
- All aluminum construction w/ steel plated quadrant
- Extended quadrant 2" (50.88mm)

MAXIMUM VELOCITY		
DIAMETER	FPM (M/S)	MAX. PRESSURE DIFFERENTIAL Inches w.g. (kpa)
4 - 8" (102 - 203mm)	2600 (13.2)	3" (0.75)
10 - 12" (254 - 305mm)	2400 (12.2)	2-1/2" (0.62)
14 - 18" (356 - 457mm)	2300 (11.7)	2" (0.50)
20 - 24" (508 - 610mm)	2300 (11.7)	1.5" (0.37)
26 - 30" (660 - 762mm)	2200 (11.2)	1.25" (0.31)
32 - 40" (813 - 1016mm)	2000 (10.2)	0.75" (0.19)

Job Name:	<input type="checkbox"/> MODEL RD (see Dwg. B-8 for performance data)	DRAWN BY:	DATE:	REV. DATE:
Location:		CLJ	2-16-93	3-22-13
Architect:		REV. NO.	APPROVED BY:	DWG. NO.:
Engineer:		20	BGT	B-3
Contractor:				